

High Power Polarization Maintaining Isolator (HPMI Series)

Specifications

Parameter	Unit	Value
Center Wavelength (λ_c)	nm	1064
Operating Wavelength Range	nm	$\lambda_c \pm 10$
Min. Extinction Ratio	dB	20
Typ. Peak Isolation	dB	35
Min. Isolation, 23 °C, all polarization states	dB	28
Max. Insertion Loss, 23 °C @ 300 mW	dB	1.6
Max. Insertion Loss, 23 °C @ 1 W	dB	2.2
Max. Insertion Loss, 23 °C @ 2 W	dB	2.7
Min. Return Loss (Input/Output)	dB	50/50
Max. Average Optical Power	W	2
Max. Peak Power for ns pulse	kW	10
Max. Tensile Load	N	5
Fiber Type		Specified by ordering info
Operating Temperature	°C	10 to +50
Storage Temperature	°C	0 to +60

IL is 0.3 dB higher, RL is 5 dB lower, ER is 2 dB lower and Optical Power is 1W only for each connector added.
Connector key is aligned to slow axis.

Package Dimensions

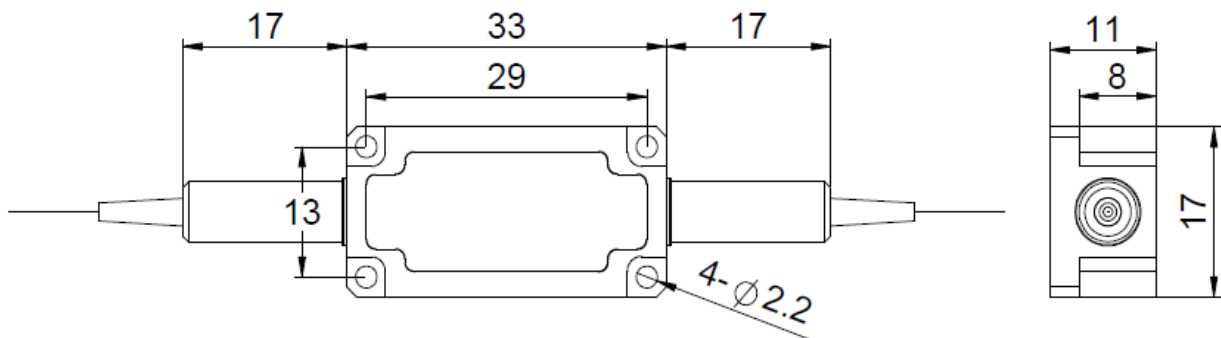

Ordering Information

HPMI2-①-②-③-④-⑤-⑥-⑦-⑧

①: Wavelength	06 - 1064 nm, SS - Specify
②: Handling Power	01 - 1 W, 02 - 2 W, SS - Specify
③: Connector Type	1 - FC/UPC, 2 - FC/APC, N - None, S - Specify
④: Fiber Type	1 - PM980 fiber, 2 - FUD-3460 PM10/125 fiber, 3 - PLMA-GDF-10/125-M, S - Specify
⑤: Fiber Jacket	B - Bare fiber, L - 900 μ m loose tube, S - Specify
⑥: Fiber Length	1 - 1.0 m, S - Specify
⑦: Working Axis	F - Fast axis blocked, B - Both axes working
⑧: Power Type	P - Pulse Application, C - Continuous Wave